

CREALITY

3D Printer User Manual

3D打印机使用说明书

CR-X Pro

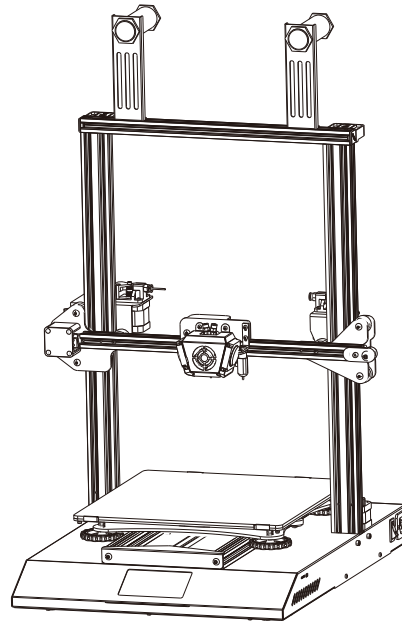

V.1.0

Content 目录

Dear Consumers,

Thank you for choosing our products. For the best experience, please read the instructions before operating the Printer. Our teams will always be ready to render you the best services. Please contact us via the phone number or e-mail address provided at the end when you encounter any problem with the Printer.

For a better experience in using our product, you can also learn how to use the Printer in the following ways:

View the accompanied instructions and videos in the Storage card.

Visit our official website www.creality.com to find relevant software/hardware information, contact details and operation and maintenance instructions.

尊敬的创想三维用户：

感谢您选择、使用创想三维的产品。为了您使用方便，请您在使用之前仔细阅读该说明书，并严格按照说明书的指示进行操作。

创想三维团队时刻准备为您提供优质的服务。在使用过程中无论遇到什么问题，请按照说明书结尾所提供的电话、邮箱与我们联系。

为了您能够更好地体验我们的产品，您还可以从以下方式获取设备操作知识：

随机使用说明：你可以在存储卡内找到相关使用说明及视频。

创想三维官网：www.cxsw3d.com 您可以登陆创想三维官网寻找相关软硬件、联系方式、设备操作、设备保养等信息。

A

Notes

使用须知

B

Assemble the 3D Printer

组装 3D 打印机

C

Use the 3D Printer

使用 3D 打印机

Level the Heated Bed

调平

Load Filament

装料

Start Printing

开始打印

NOTES 使用须知

1. Do not use the printer any way other than described herein in order to avoid personal injury or property damage.
2. Do not place the printer near any heat source or flammable or explosive objects. We suggest placing it in a well-ventilated, low-dust environment.
3. Do not expose the printer to violent vibration or any unstable environment, as this may cause poor print quality.
4. Before using experimental or exotic filaments, we suggest using standard filaments such as ABS or PLA to calibrate and test the machine.
5. Do not use any other power cable except the one supplied. Always use a grounded three-prong power outlet.
6. Do not touch the nozzle or printing surface during operation as they may be hot. Keep hands away from machine while in use to avoid burns or personal injury.
7. Do not wear gloves or loose clothing when operating the printer. Such cloths may become tangled in the printers moving parts leading to burns, possible bodily injury, or printer damage.
8. When cleaning debris from the printer hotend, always use the provided tools. Do not touch the nozzle directly when heated. This can cause personal injury.
9. Clean the printer frequently. Always turn the power off when cleaning, and wipe with a dry cloth to remove dust, adhered printing plastics or any other material off the frame, guide rails, or wheels. Use glass cleaner or isopropyl alcohol to clean the print surface before every print for consistent results.
10. Children under 10 years of age should not use the printer without supervision.
11. This machine is equipped with a security protection mechanism. Do not manually move the nozzle and printing platform mechanism manually while booting up, otherwise the device will automatically power off for safety.
12. Users shall comply with related nation and region's laws, regulations and ethical codes where the equipment or produced prints by it is used, and users of our product shall not use aforesaid products to print any end-use products, objects, parts or components or any other physical prints that violate the national or regional laws, regulations and ethical codes where herein referred product and produced prints by it is located.

1. 请勿尝试任何使用说明中没有描述的方法来使用本机，避免造成的意外人身伤害和财产损失；
2. 请勿将本机放置在易燃易爆物品或高热源附近，请将本机放置在通风、阴凉、少尘的环境内；
3. 请勿将打印机放置在振动较大或者其他不稳定的环境内，机器晃动会影响打印机打印质量；
4. 建议使用厂家推荐耗材，以免造成挤出头堵塞和机器损坏；
5. 请勿在安装过程中使用其他产品电源线代替，请使用本机附带的电源线，电源插头需接插在带有地线的三孔插座；
6. 请勿在打印机工作时接触喷嘴以及热床，以防止出现高温烫伤，造成人身伤害；
7. 请勿在操作机器时佩戴手套或缠绕物，以防可动部件对人身部件造成卷入挤压和切割伤害；
8. 在打印完毕后及时利用喷头的余温借助工具将喷头上的耗材清理干净，清理时请勿直接用手触摸喷头，以防出现烫伤；
9. 常做产品维护，定期在断电的情况下，用干布对打印机做机身清洁，拭去灰尘和粘结的打印材料、导轨上的异物；
10. 年龄在10岁以下的儿童，请勿在没有人员监督的情况下使用本机，以免造成人身伤害；
11. 本机设有安全保护机制，请勿在开机状态下手动快速移动喷头及打印平台机构，否则设备会自动断电关机保护；
12. 使用者应遵守设备打印产品与设备所在地及相应国家及地区法律、法规，恪守职业道德，严禁使用我司产品打印有违设备打印产品与设备所在地及相应国家、地区法律禁止的任何产品或物件。

Introduction 设备简介

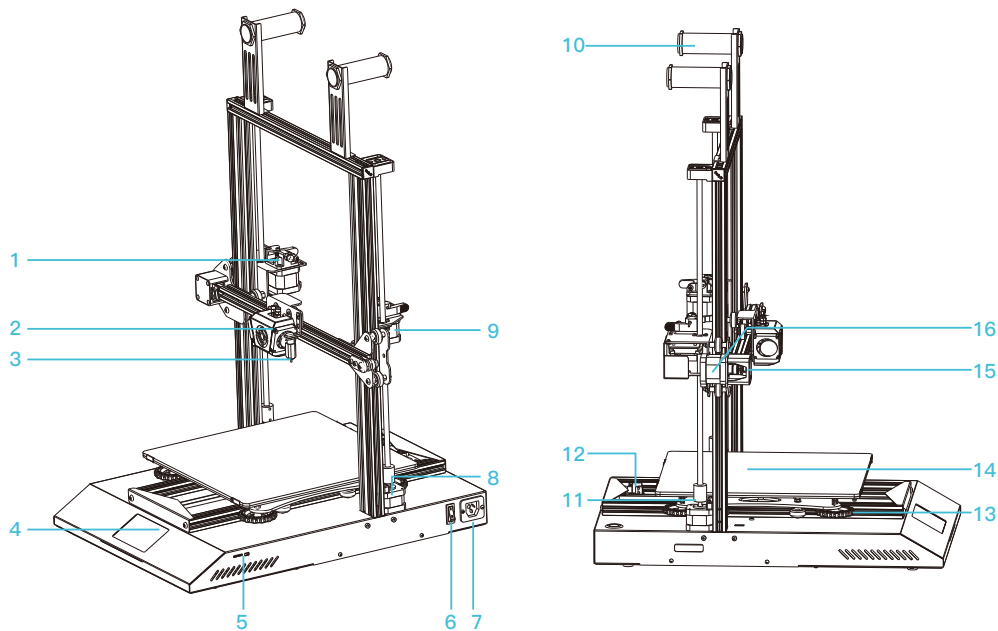

- 1 Extruder 1 (E1) | 挤出(E1) 机电机
- 2 Nozzle Kit | 喷头套件
- 3 BL Touch | BL Touch
- 4 Touch Screen | 触摸屏
- 5 TF Slot & USB Port | TF卡槽 & USB 接口
- 6 Power Switch | 电源开关

- 7 Power Socket | 电源插口
- 8 Z-axis Motor | Z轴电机
- 9 Extruder 2 (E2) | 挤出(E2) 机电机
- 10 Filament Holder | 料架
- 11 Coupling | 联轴器

- 12 Y Limit Switch | Y轴限位开关
- 13 Larger Hand Twist Nut | 调平大螺母
- 14 Platform | 打印平台
- 15 X Limit Switch | X轴限位开关
- 16 X Stepper | X轴电机

Parameters 设备参数

Basic Parameters 基本参数	
Model 型号	CR-X Pro
Printing Size 成型尺寸	300*300*400mm/270X270X400mm (Dual color 双色)
Molding Tech 成型技术	FDM
Nozzle Number 喷头数量	1
Slice Thickness 切片层厚	0.1mm-0.4mm
Nozzle Diameter 喷嘴直径	Standard 0.4mm 标配0.4mm
Precision 打印精度	±0.1mm
Filament 打印材料	1.75mm PLA
File Format 切片支持格式	STL/OBJ/AMF
Working Mode 打印方式	Online or TF card offline 联机或TF卡脱机
Slice Software 可兼容切片软件	Creativity Slicer/Cura/Repetier-Host/Simplify3D
Power Supply 额定电压	Input 输入:100-240V 50/60Hz Output 输出:24V
Total Power 额定功率	480W
Bed Temp 热床最高温度	≤100°C
Nozzle Temp 喷嘴最高温度	≤250°C
Resume Print 断电续打	Yes 支持
Filament Detector 断料检测	No 不支持
language Selection 中英切换	Yes 支持
Operating System 电脑操作系统	Windows XP/7/8/10 MAC/Linux
Printing Speed 打印速度	≤180mm/s,Normal 正常为 30-60mm/s

Parts List 零部件清单

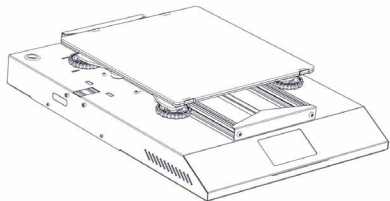

1 Base Frame | 底座 x 1

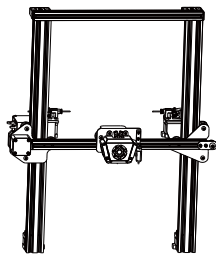

2 Gantry Frame | 龙门架 x 1



3 Tool Box | 工具包 x 1



4 Filament | 耗材 x 1

Tool List 工具包清单



5 Hex keys, Wrench x 1 & Screwdriver
扳手和螺丝刀



9 0.4mm Nozzle x 1
Cleaner
通针



12 Power Cord x 1
电源线



15 Spare Parts x 1
备件



6 TF Card & Reader x 1
TF卡和读卡器



10 Filament Holder x 2
Bracket
料架



13 USB Cord x 1
USB线



16 M5*25 Sems Screw x 4
M5*25组合螺丝



7 Spade x 1
铲刀

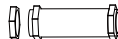

11 Spool & Nuts x 2
料管及料管螺母



14 PTFE Tube x 1
铁氟龙管



17 Hexagon socket flat round screw M4x8
内六角平圆头M4x8



8 Pliers x 1
剪钳



18 M4 T-nut x 4
M4 T型螺母

1

Device Installation 设备安装



1 Base Frame | 底座 ×1

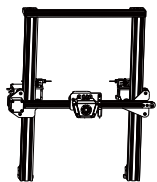

2 Gantry Frame | 龙门架 ×1



16 M5*25 Sems Screw ×4
M5*25组合螺丝

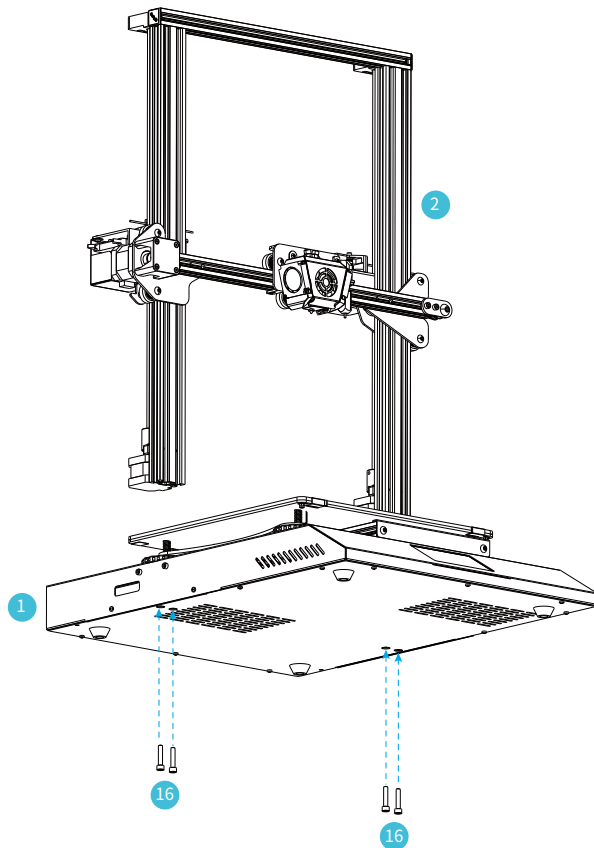

2

Filament Holder Installation
料架安装

- 10 Filament Holder x2
Bracket
料架

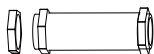

- 11 Spool & Nuts x2
料管及料管螺母



- 17 Hexagon socket flat
round screw M4x8
内六角平圆头M4x8



- 18 M4 T-nut x4
M4 T型螺母

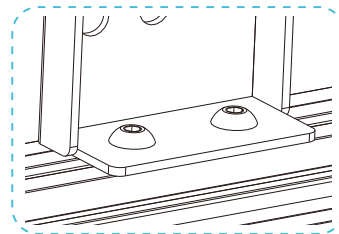
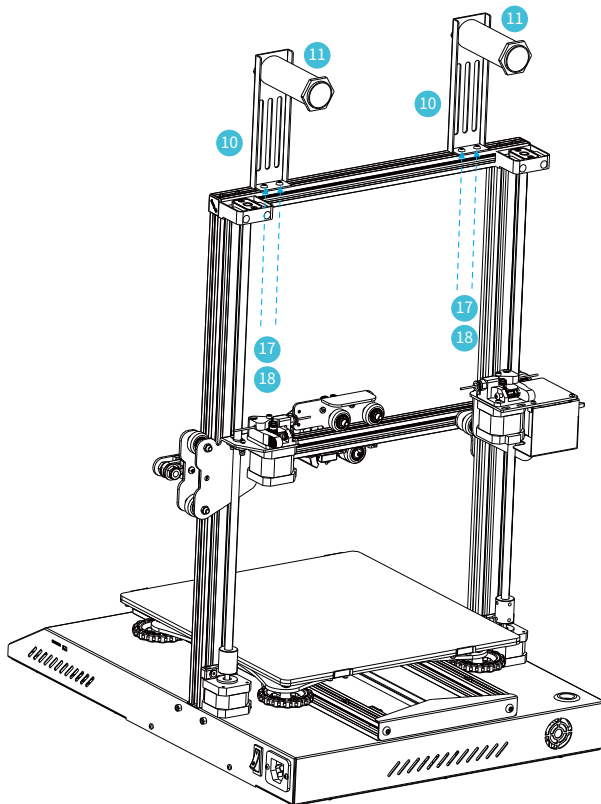

3

Cable Connection 设备接线

1. Connect the 6pin (4-wire) ports to Z1 and Z2 stepper motors as shown in the figure. 1. 按图示将6pin (4线) 端口分别连接Z1、Z2步进电机。
2. Connect the cable to the cable socket on the adapter board. 2. 将排线连接到转接板上的排线插座。

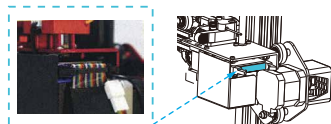
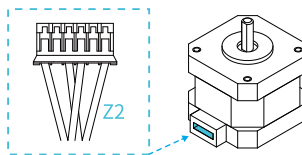
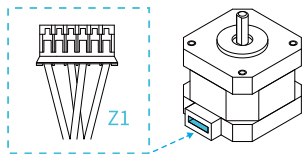

Ribbon Cable
排线

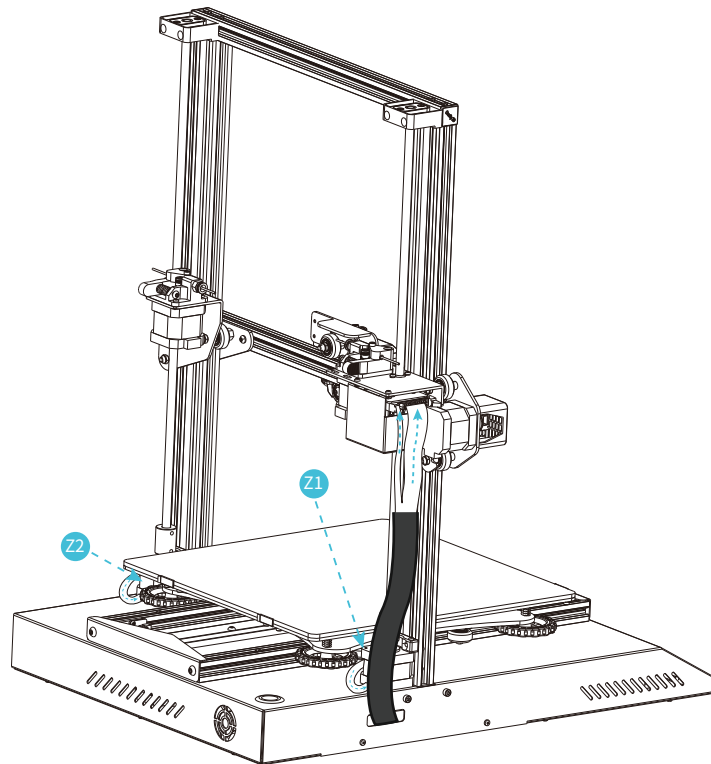

4

Screen Information

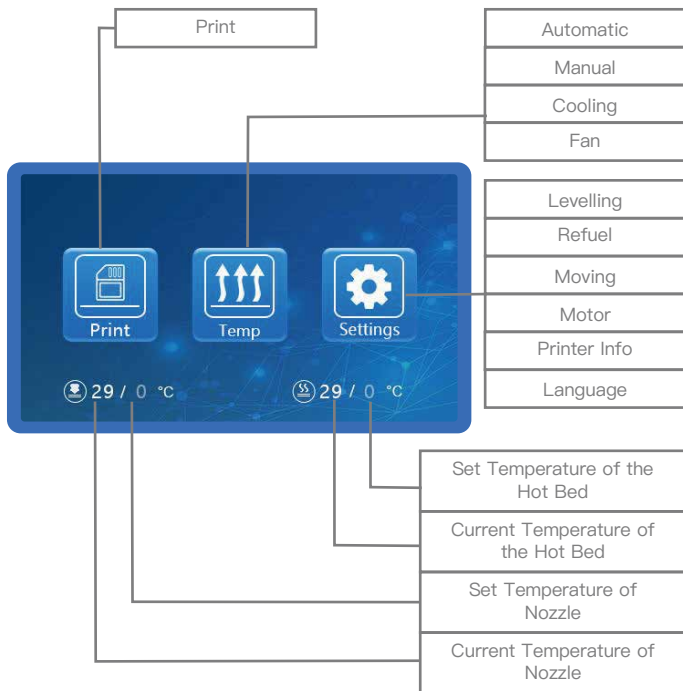

Screen Info.					
Main Menu	Sub Menu	Explanation			
Print	Selected File	Stop			
		Pause			
		Printing Speed			
		Nozzle Temp.			
		Hot-bed Preheat			
		Fan(off\on)			
Temp	Automatic	PLA\ABS (195°\240°)			
	Manual	Nozzle Preheat			
	Cooling	Hot-bed Preheat			
	Fan	yes\no			
Settings	Levelling	(off\on)			
	Refuel	Please Click Numbers to Assist Levelling (①~⑤)			
	Moving	Withdraw			
	Motor off	Feed			
	Language	X-axis	Y-axis	Z-axis	The origin
	Printer Info	yes\no			
	Printer Info	English\Chinese			
	Printer Info	Machine Type、 Firmware Version、 Printing Size、 Website			
	Printer Info				
	Printer Info				

4

开机信息

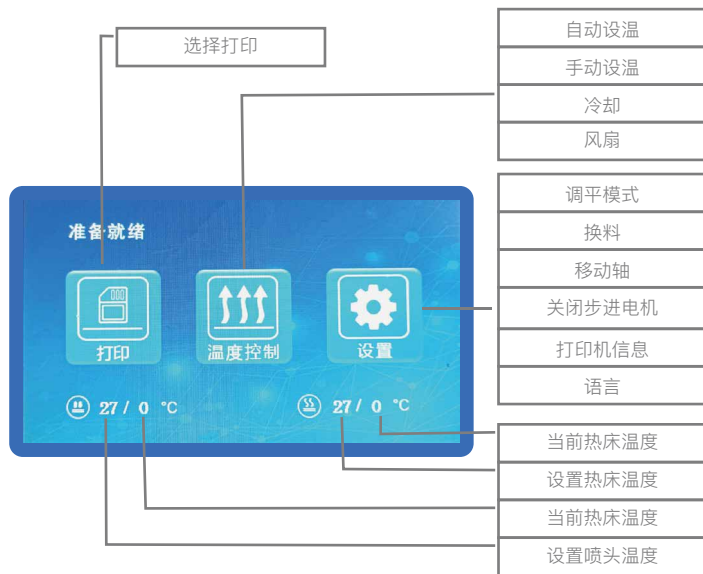

屏幕信息					
主目录	初级目录	解释说明			
打印	选择打印	停止			
		暂停			
		调整	打印速度		
			喷头温度		
			热床温度		
风扇					
温度控制	自动设温	PLA\ABS (195°\240°)			
	手动设温	喷头预热			
		热床预热			
	冷却	是\否			
	风扇	开\关			
设置	手动调平	请点击数字 (①~⑤) 进行辅助调平.....			
	换料	退料			
		进料			
	移动轴	X轴	Y轴	Z轴	原点
	关闭步进电机	是\否			
	语言	英文\中文			
	打印机信息	设备型号、固件版本、打印尺寸、公司网站			

5

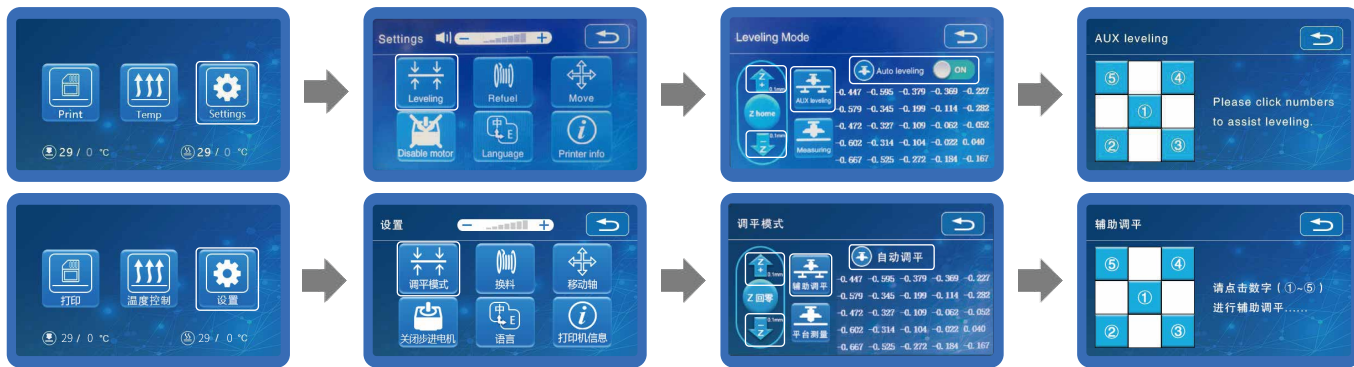
Bed Levelling
调平平台

1. Slightly tighten the four levelling nuts at the bottom of the platform before initial levelling.
2. Select "Settings" → "Level mode", click on the number ②.
3. Adjust the platform height by turning the knob underneath. Use an adjustment, making sure that the nozzle lightly presses on the paper.
4. Complete the adjustment on all 4 corners.
5. Click the number ① to test the platform height in the middle.
6. Repeat above steps one or two times if necessary.

1. 初次调平前，拧紧平台底部的四个调平螺母。
2. 选择设置→调平，点击数字②。
3. 拧动平台下面的旋钮来调整平台高度，调节打印平台喷嘴使二者处于刚好贴合状态，间距约0.05mm，我们可以利用一张A4纸辅助调平，使喷嘴刚好能在A4纸上产生划痕。
4. 完成所有4个角的螺钉调整。
5. 点击①号，测试平台中间间隙是否合适。
6. 如有必要可重复，上述步骤1-2次。

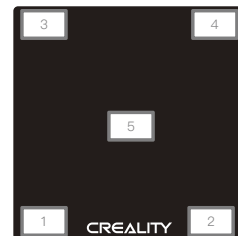
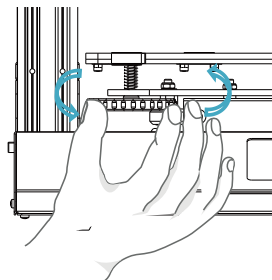

Automatic leveling 自动调平

If you need to do automatic leveling ,you can change it in the following interface:

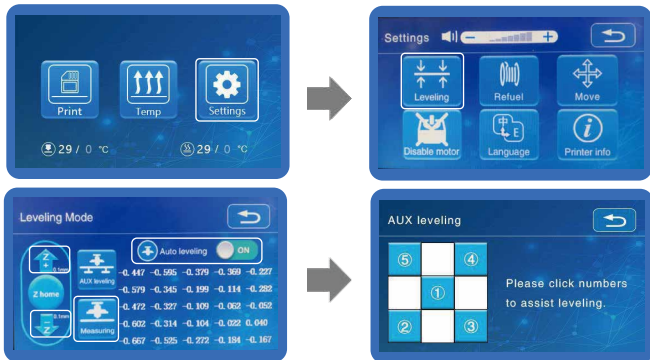

如果需要自动调平，可以在以下界面中进行更改：

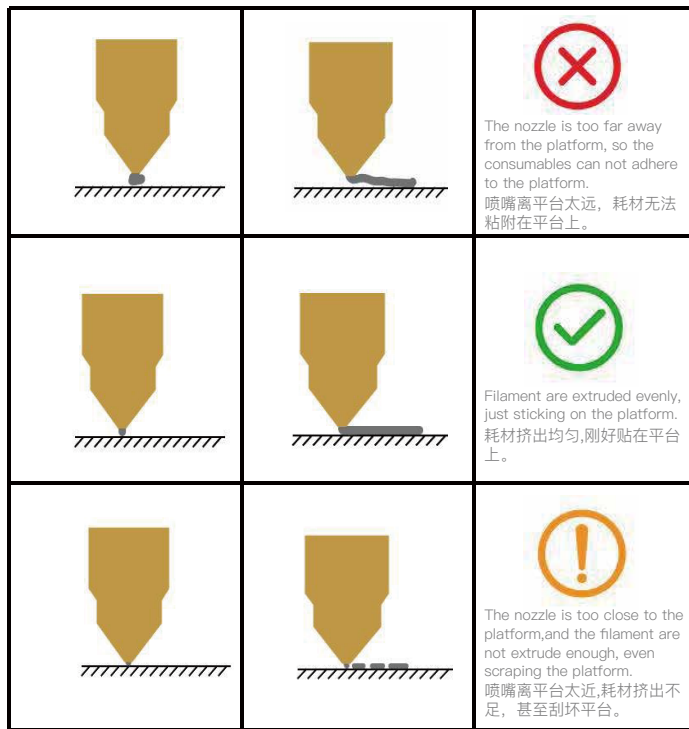
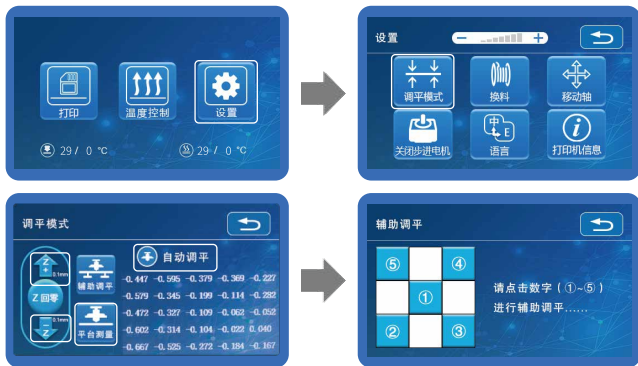

6

Preheat
预热

Method 1

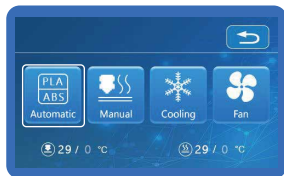

方法一



Method 2

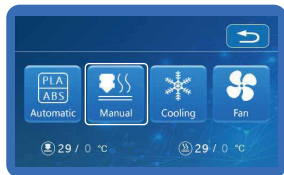
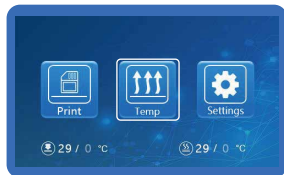

方法二

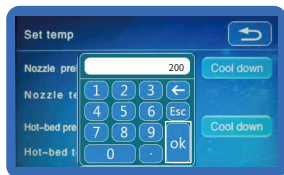
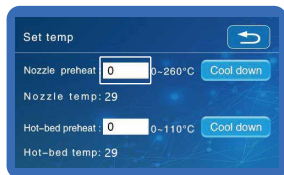

7

Loading Filament 装料

Press and hold the extrusion clamp, insert the consumable from the feed port to the position above the small pneumatic connector, and the consumable will be quickly extruded during printing. Before each printing, make sure to check the consumables to ensure the position above the small pneumatic connector to ensure printing, otherwise it will cause blockage during printing.

按住挤出夹，从进料口插入耗材到小气动接头上方的位置，打印时会快速挤出耗材。每次打印之前，请确认检查耗材确保在小气动接头上方的位置，以确保打印，否则会导致打印过程中堵塞。

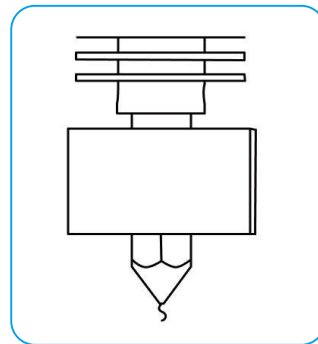
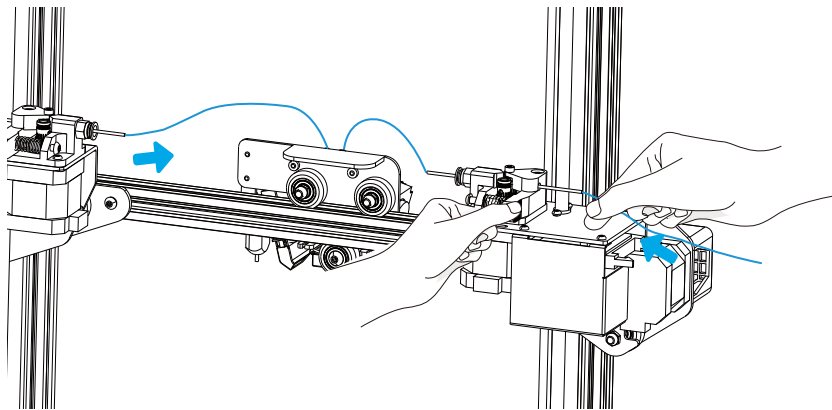

Tips: How to replace the Filament?

Two-color printing: quickly draw out the consumables after the nozzle is warmed up, and send the new consumables to the position above the small pneumatic joint.

Tips:如何更换耗材?

双色打印:在喷嘴预热后迅速抽出耗材，并将新的耗材送至小气动接头上方的位置。

8

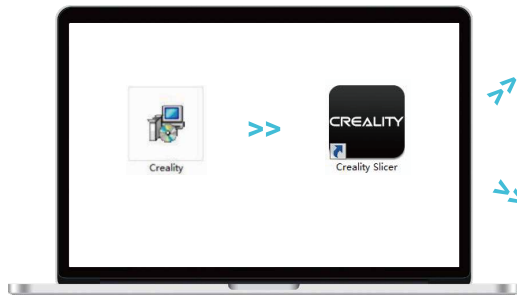
Install Software
安装软件

1. Double click to install the software. | 安装软件
2. Double click to open the software. | 打开软件

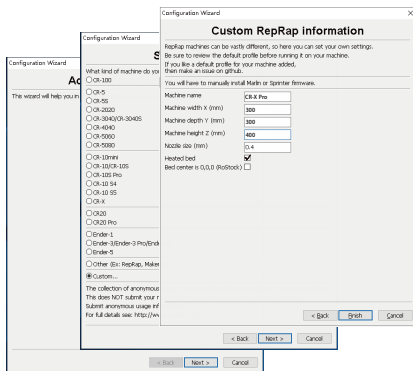

3. Select language→Next→Select your machine→Next→Finish.

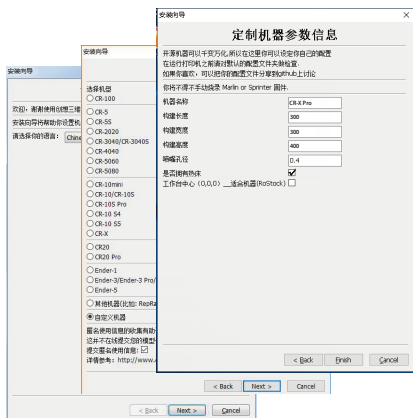

3. 依次选择语言→Next→选择对应机型→Next→Finish, 完成设置。



4. Open the software→Load→Select the file→Wait for slicing to finish
打开创想三维切片软件→Load (读取文件)→选择文件

9

Slicing
切片

1. Insert TE card into computer with Reader. 2.Open imagination 3D slicing software → Load (read file) → select file → save (save gcode file to TF card)
1.用读卡器将卡插入计算机。2.打开创想三维切片软件→Load (读取文件) →选择文件→保存(保存gcode文件到TF卡)

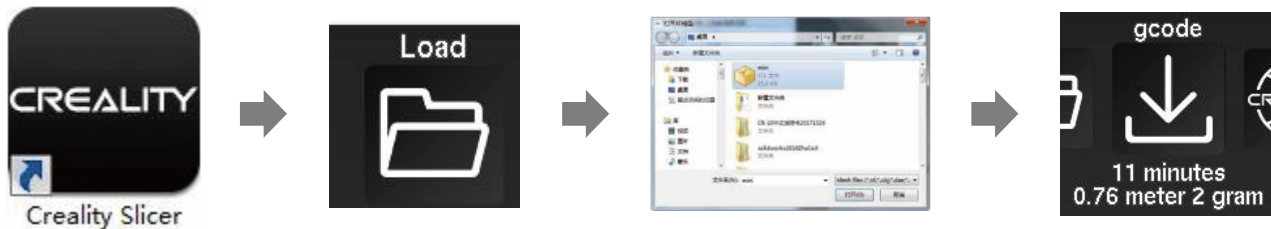

- 3.How to print in two colors (Dual-Color printer) Load all parts of models.
3.如何用两种颜色 (双色打印机) 打印模型的所有零件



R- Click to merge models

右键合并模型



Notes: File name must be English or numbers, not Chinese or special symbols

温馨提示：文件名需为英文或数字，不能为中文或特殊符号

10

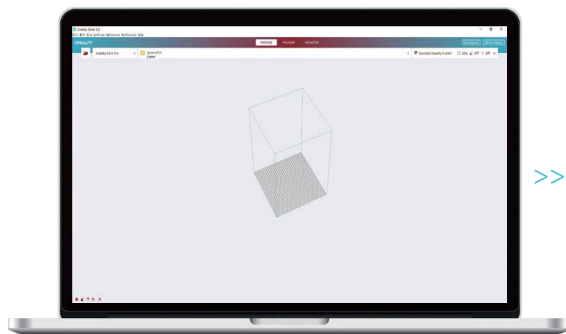
Start Printing
开始打印

4. Generate G-code, and save the gcode file to storage card.
生成 G 代码→保存

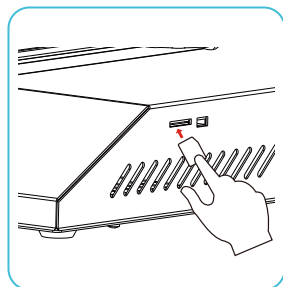

5. Insert the storage card→ Print
→ Select the file to be printed.
插入存储卡→点击打印控件→
选择要打印的文件

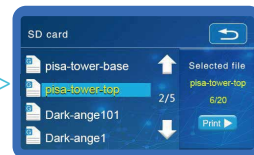
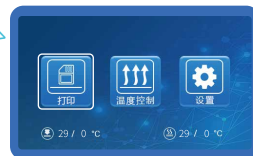

File names must be Latin letters or numbers, not Chinese characters or other special symbols
文件名需为拉丁字母或数字, 不能为汉字或其他特殊符号



Notes: For details on the software instructions, please to the slicing software manual in the memory card!
温馨提示: 软件使用说明详情, 请见存储卡内切片软件使用手册!



Warning: Please don't insert or remove TF card or SD card during printing.
警告: 在打印过程中, 禁止插拔TF卡或SD卡。

11

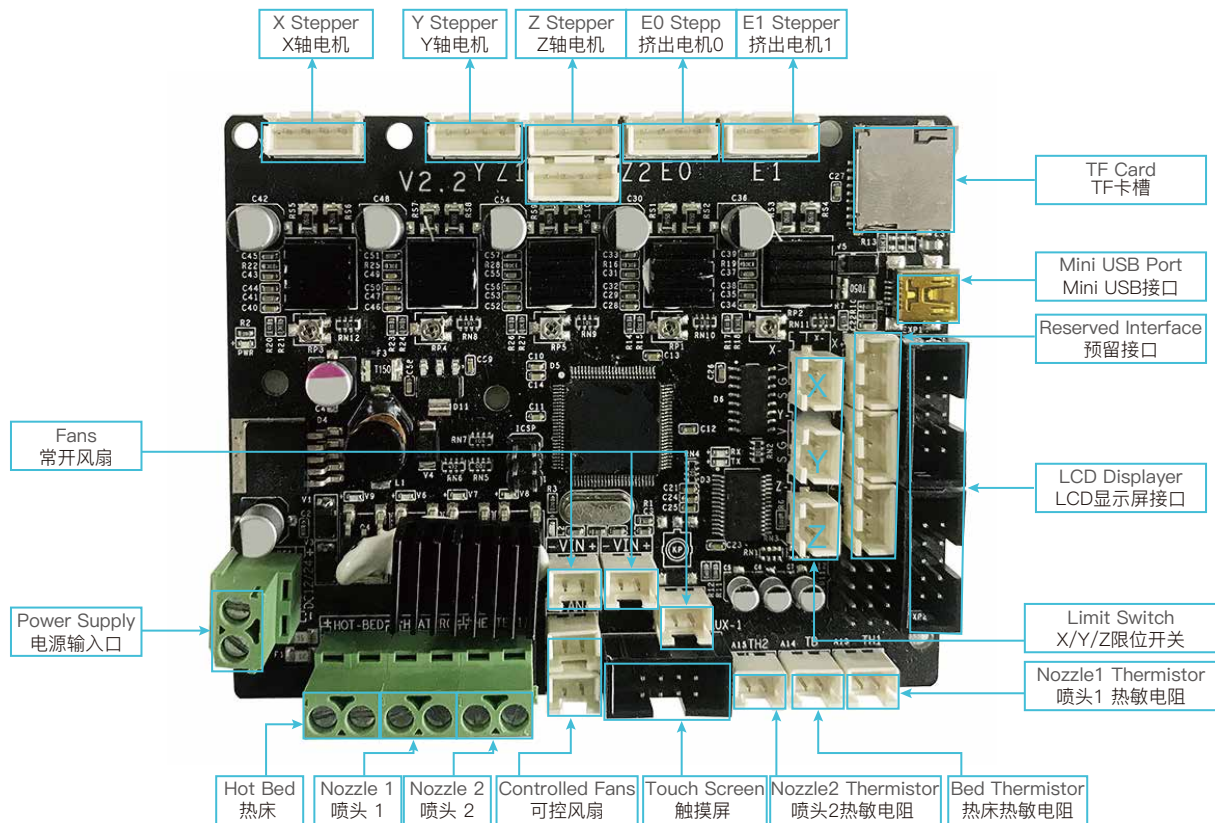
Circuit Wiring
电路接线

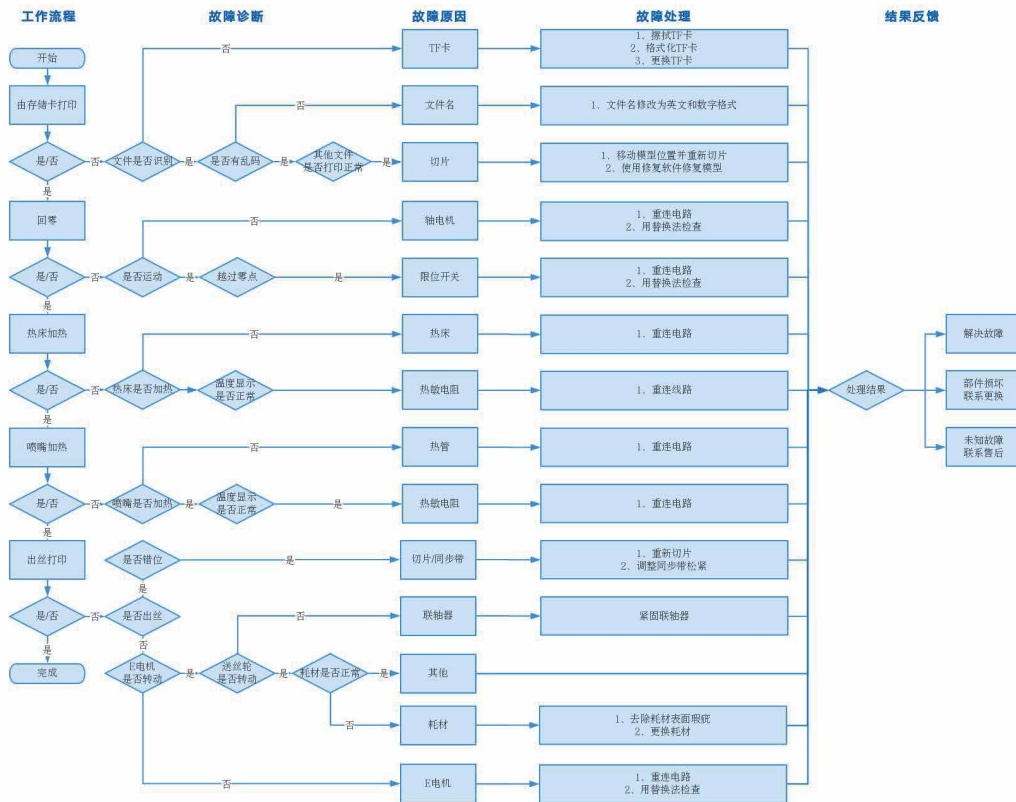

Due to the differences between different machine models, the physical objects and the final images can differ. The final explanation rights shall be reserved by Shenzhen Creality 3D Technology Co., Ltd.

因每款机型不同,实物与图可能有所差异,请以实物为准,最终解释归深圳市创想三维科技有限公司所有。



SHENZHEN CREALITY 3D TECHNOLOGY CO.,LTD.

11F & Room 1201,Block 3,JinChengYuan,Tongsheng Community,
Dalang,Longhua District,Shenzhen,China,518109
Official Website: www.creality.com
Tel: +86 755-8523 4565
E-mail: info@creality.com cs@creality.com



深圳市创想三维科技有限公司

深圳市龙华区大浪街道同胜社区金城工业园第三栋1201、11层
公司网站: www.cxsw3d.com
服务热线: 400 6133 882
0755-8523 4565

