

## How to replace the mainboard

The mainboard functions as the printer's main operating system. It determines how the fan, the motor, and the LCD functions. In the following article, we'll show you how to remove the old mainboard and install the new mainboard.

### SONIC MINI 8K S

#### Removal of the Old Mainboard:

**Step 1:** Turn off the printer and remove the UV cover, resin vat, and building plate.

**Step 2:** Carefully lay down your printer.

**Step 3:** Loosen the 4 screws on the bottom case, and then open the case.

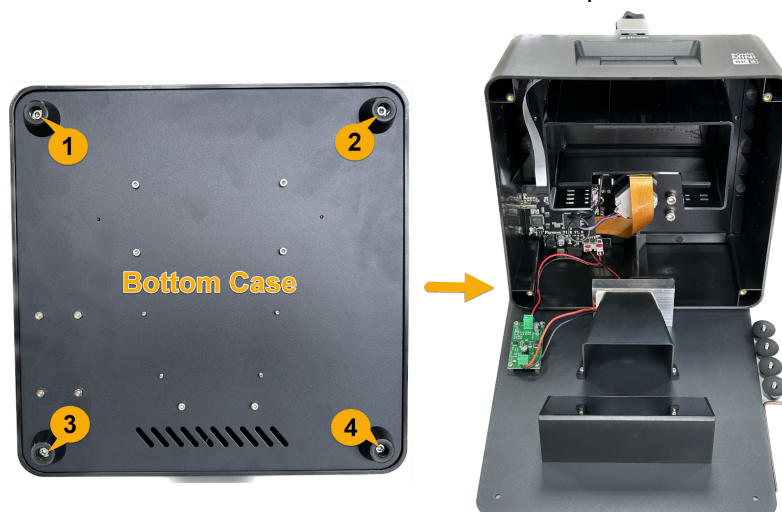

**Step 4:** Disconnect all cables/ wires (see the below picture) that are linked to the mainboard.

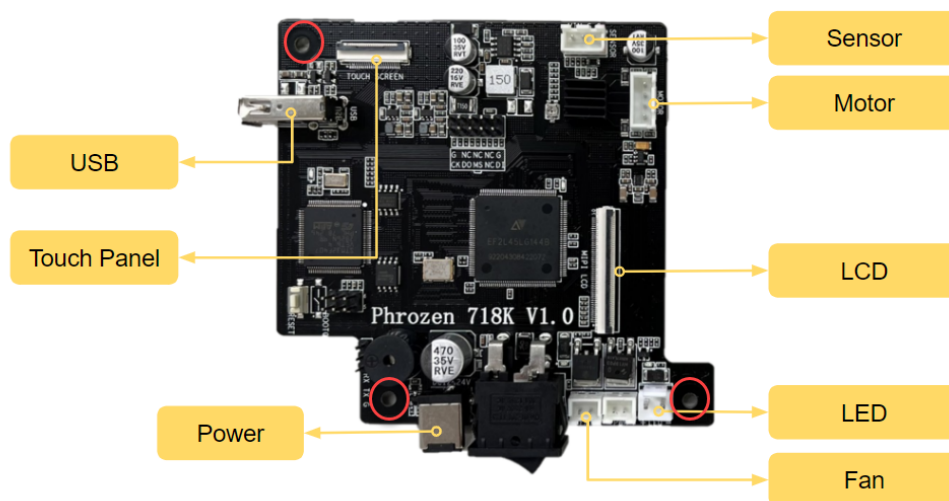

**Note:**

Make sure to fold up the cable clip before removing the ribbon cables.

**Step 5:** Loosen the three screws located at the corners of the mainboard (see red circle shown above).

**Step 6:** Remove the old mainboard.

**Installation of the New Mainboard:**

**Step 1:** Place the new mainboard, and make sure the USB port and the power cable port are in place.

**Step 2:** Reattach the all the cables and wires on the mainboard.

**Step 3:** Install the front cover.

**Step 4:** Perform dry run test to ensure that the mainboard is functioning properly.

**Step 5:** Done.